

POSITILT®
PTAM2
Inclination Sensor with Analog Output

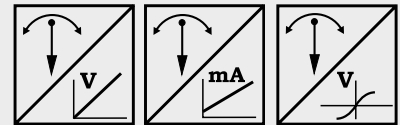

Analog inclination sensor with 1 or 2 axes

- Linear output of the inclination angle
- Measurement range $\pm 180^\circ$ with 1 axis, $\pm 60^\circ$ with 2 axes
- Contact-free, wear free, high resolution
- High shock resistance
- Protection class IP67 / IP69K
- Analog output
- Limit switch



Specifications	Output: inclination angle as	Voltage 0.5 ... 10 V Current 4 ... 20 mA Voltage $\sin(x)$
	Excitation voltage	36 V DC
Measurement range	Single axis: $\pm 5 \dots \pm 180^\circ$; dual axes: $\pm 5 \dots \pm 60^\circ$	
Linearity	0.5 °	
Resolution	0.05°	
Repeatability	0.1°	
Settling time	<0.1 s	
Switching outputs	Limit switch, 200 mA	
Connection	4 or 8 pin connector M12 / cable	
Protection class	IP67/IP69K	
Stability (temperature)	$\pm 100 \times 10^{-6} / ^\circ\text{C}$ f.s.	
Environmental		
EMC	Refer to output specification	
Temperature	Refer to output specification	

1 axis

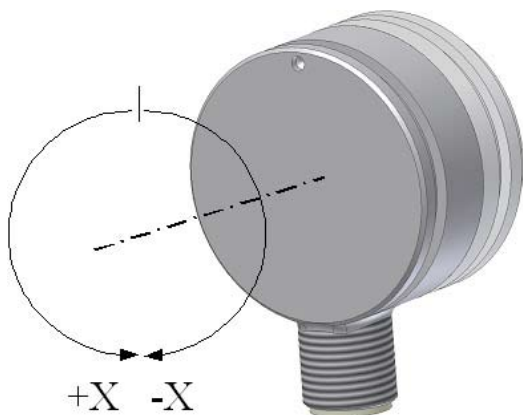

2 axes

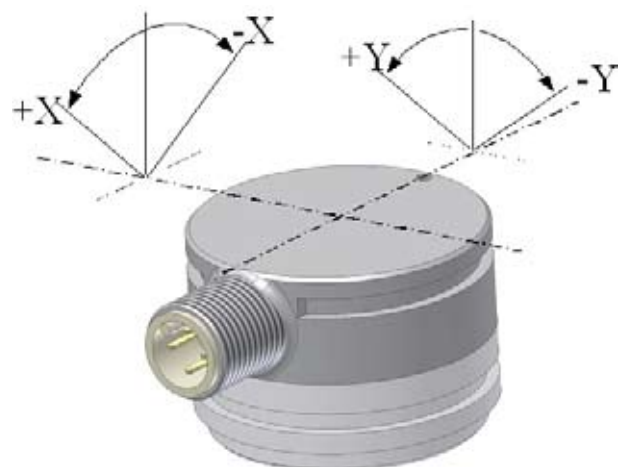

POSITILT® PTAM2 Inclination Sensor with CANopen Output



Analog inclination sensor with 1 or 2 axes

- Linear output of the inclination angle
- Measurement range $\pm 180^\circ$ with 1 axis, $\pm 60^\circ$ with 2 axes
- Contact-free, wear free, high resolution
- High shock resistance
- Protection class IP67 / IP69K
- CANopen bus

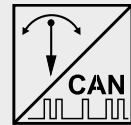

Specifications	Output	CANopen bus (profile „inclination sensor“)
	Excitation voltage	36 V DC
	Measurement range	Single axis: $\pm 5 \dots \pm 180^\circ$; dual axis: $\pm 5 \dots \pm 60^\circ$
	Linearity	0.5 °
	Resolution	0.05°
	Repeatability	0.1°
	Settling time	<0.1 s
	Protection class	IP67/IP69K
	Stability (temperature)	$\pm 100 \times 10^{-6} / ^\circ\text{C}$ f.s.
Interface CANOP	Communication profile	CANopen CiA 301 V 4.02, Slave
	Encoder profile	CiA 406 Inclinometer
	Error Control	Node Guarding, Heartbeat, Emergency Message
	Node ID	Adjustable via LSS
	PDO	3 TxPDO, 0 RxPDO, no linking, static mapping
	PDO Modes	Event-/Time triggered, Remote-request, Sync cyclic/acyclic
	SDO	1 server, 0 client
	CAM	2 cams
	Certified	Yes
	Transmission rates	50 kBaud to 1 Mbaud, adjustable via LSS
	Nodes	127 max.
	Bus connection	M12 connector, 5 pins
	Integrated bus terminating resistor	No
Bus, galvanic isolated	No	



Signal wiring / connection	Signal name	Connector pin
	Shield	1
	Excitation +	2
	GND	3
	CAN-H	4
	CAN-L	5

View to sensor connector

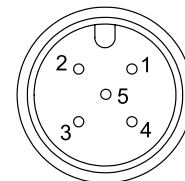

CAN bus wiring

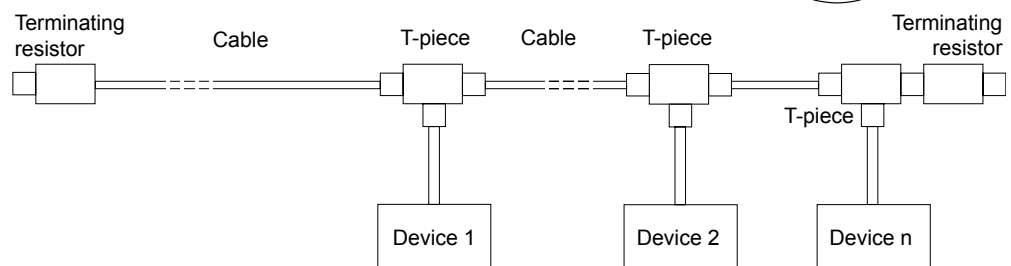

POSITILT®
PTAM2
Inclination Sensor

PRELIMINARY



Outline drawing
M12 axial

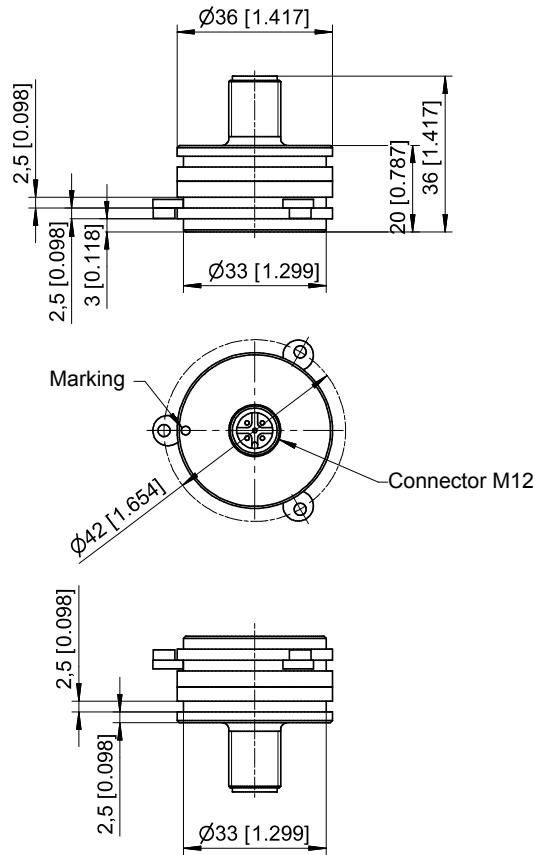

Outline drawing
M12 radial

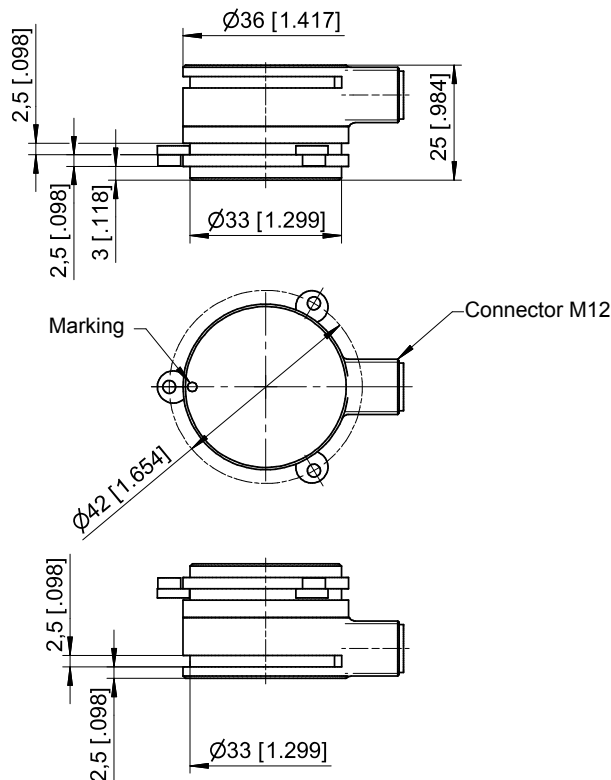

Dimensions in mm [inch]

Dimensions informative only.
 For guaranteed dimensions consult factory.

POSITILT®
PTAM2
Inclination Sensor

PRELIMINARY



Outline drawing
Cable output

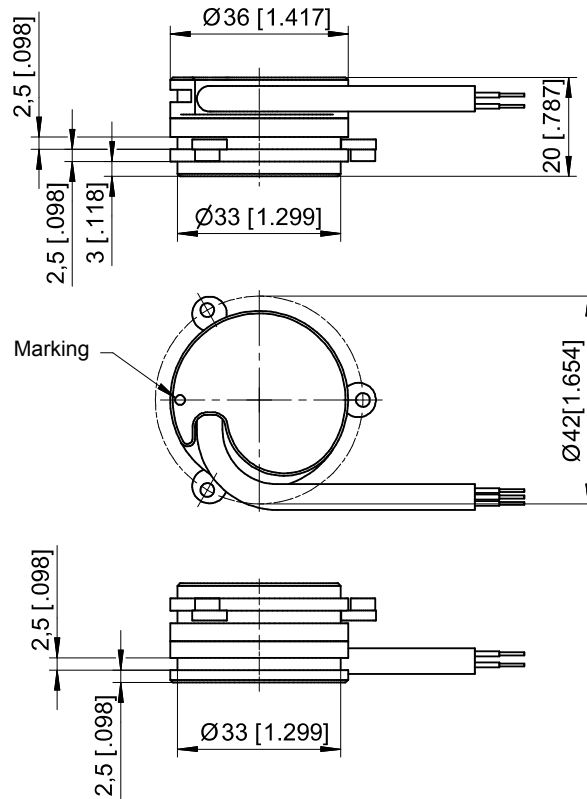

Dimensions in mm [inch]

Dimensions informative only.

For guaranteed dimensions consult factory.