

DMi Model: XPDH

DIFFERENTIAL PRESSURE TRANSDUCER



PERFORMANCE SPECIFICATIONS

(FSO is Full Scale Output)

PRESSURE RANGES: 2000 thru 10,000 psid

EXCITATION: 10 VDC

OUTPUT: 2 mV/V

BRIDGE RESISTANCE: 350 ohms

ZERO BALANCE: ±1.0% FSO

LINEARITY: } ±0.25% FSO, Combined

HYSTERESIS: } ±0.05% FSO

REPEATABILITY: ±0.05% FSO

OPERATING TEMP RANGE: -65° to +250°F

COMPENSATED TEMP RANGE: +60° to +160°F

THERMAL EFFECTS on ZERO: ±0.50% FSO/100°F

THERMAL EFFECTS on SPAN: ±0.50% Reading/100°F

MAXIMUM LINE PRESSURE: 2000 psi

MAXIMUM OVERPRESSURE:

SAFE-Either Side

2000 to 3000 psid

100% over capacity

5000 to 10,000 psid

50% over capacity

WETTED PARTS:

Stainless Steel

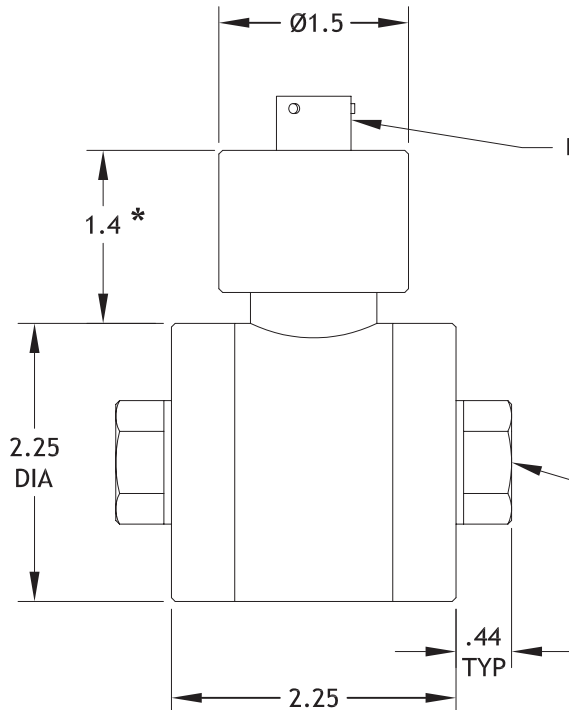

BENDIX PTIH-10-6P OR EQUAL

WIRING CODE/Connector:

PIN A & B +Input

PIN C & D -Input

PIN E -Output

PIN F +Output

PRESSURE PORT, BOTH ENDS:
1/4-18NPT FEMALE WITH 7/8 HEX

PART NUMBER EXAMPLES:

PART NUMBER	RANGE
XPDH-2K5D	2500 PSID
XPDH-05KD	5000 PSID
XPDH-10KD	10000 PSID

* 2.5 FOR AMPLIFIED VERSION

All dimensions are inches, unless otherwise noted.

-AMPLIFIED VERSIONS AVAILABLE,
CONSULT FACTORY