

DMi Model: XPI-1A

## INDUSTRIAL PRESSURE TRANSMITTER 4-20 mA



### PERFORMANCE SPECIFICATIONS (FSO is Full Scale Output)

EXCITATION: 12-40 VDC  
 OUTPUT: 4-20 mA  $\pm$ 5% adjustable  
 ZERO BALANCE: 4 mA  $\pm$ 5% adjustable

LINEARITY:  $\pm$ 0.15% FSO  
 HYSTERESIS:  $\pm$ 0.05% FSO  
 REPEATABILITY:  $\pm$ 0.05% FSO

OPERATING TEMP RANGE: -50 to +250 °F (-46 to +121 °C)  
 COMPENSATED TEMP RANGE: +60 to +160 °F (+15 to +71 °C)  
 THERMAL EFFECTS on ZERO:  $\pm$ 0.005% FSO/°F  
 THERMAL EFFECTS on SPAN:  $\pm$ 0.005% Reading/°F

PROOF PRESSURE: 150% of Rated Pressure  
 BURST PRESSURE: 300% of Rated Pressure

MATERIAL-Wetted Parts: 17-4 PH Stainless Steel

### WIRING CODE/

Connector:

PIN A +Supply  
 PIN D +Output  
 PIN E Case Ground  
 PINS B,C & F No Connection

BENDIX PTIH-10-6P OR EQUAL

ZERO ADJUSTMENT COVER,  
 SPAN ADJUSTMENT COVER, OTHER SIDE

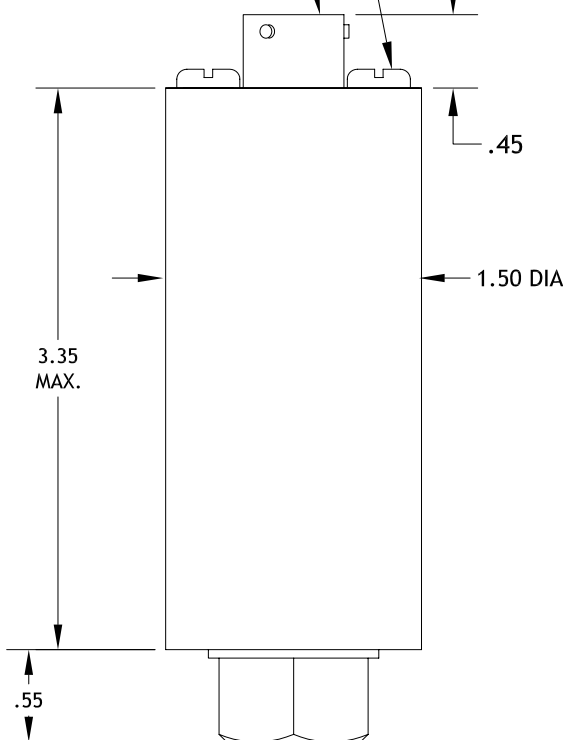

### HOW TO ORDER:

**XPI-1A-100G-PA**

PRESSURE CONNECTION  
 EX: PC = 7/16-20 FEMALE PER MS33649-04  
 PA = 1/4 NPT FEMALE

PRESSURE REFERENCE  
 EX: G = GAGE (PSIG)  
 A = ABSOLUTE (PSIA)

RANGE / CAPACITY  
 EX: 050 = 50 PSI  
 250 = 250 PSI  
 01K = 1000 PSI  
 7K5 = 7500 PSI  
 10K = 10 000 PSI

### PART NUMBER EXAMPLES:

PART NUMBER	RANGE	PRESSURE PORT
XPI-1A-200A-PC	200 PSIA	7/16-20 FEMALE
XPI-1A-7K5G-PC	7500 PSIG	7/16-20 FEMALE
XPI-1A-01KG-PC	1000 PSIG	7/16-20 FEMALE
XPI-1A-500G-PA	500 PSIG	1/4 NPT FEMALE

All dimensions are inches, unless otherwise noted.